

Elegant Jacobsen wraps around pool

By Associated Designs

The Jacobsen is a totally contemporary single-level plan with two distinct wings that wrap around a central courtyard with a large pool at center. The central courtyard can be enjoyed whether you're in the owners' suite, foyer, dining room, kitchen or living room.

Stucco columns and raised stucco trim accent the gently arched openings of the lofty entry and two front windows, each filled with a sparkling expanse of glass. Inside the majestic vaulted foyer, an abundance of natural light spills down through two arched transoms (front and rear). More washes in through double atrium doors that provide a view of, as well as access to, the pool.

Family gathering spaces and a utility room are to the left; sleeping quarters are to the right. The room closest to the entry could be used as a home office, den, library, or whatever is needed.

Dining room, kitchen and living room flow together, in a large room where stepped ceiling variations help define the spaces. Kitchen features include built-in appliances, a walk-in pantry, a garden window, and a large work island rimmed by a raised eating bar.

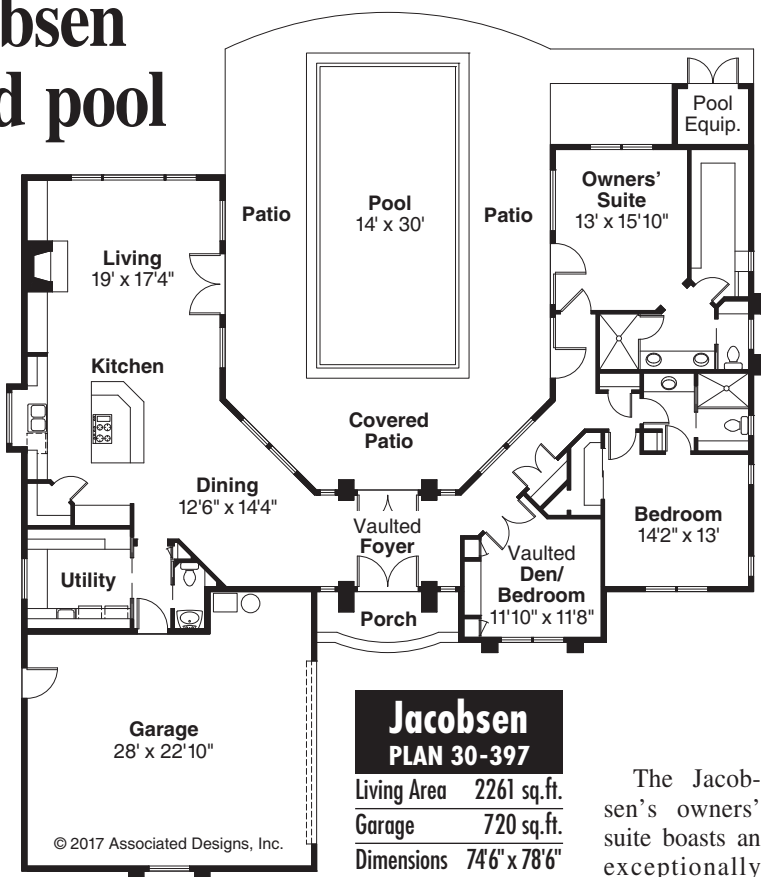

Jacobsen
PLAN 30-397

Living Area	2261 sq.ft.
Garage	720 sq.ft.
Dimensions	74'6" x 78'6"

2000 SERIES
www.AssociatedDesigns.com

Laundry appliances and a powder room are just around the corner, off a hallway that links the kitchen to a two-car garage. The utility room is larger than most. A built-in desk on one side could house the family computer or a sewing machine, and the long counter next to the broom closet is perfect for folding clothes.

with a shower, double vanity and separately enclosed toilet. Secondary bedrooms share yet another bathroom.

Associated Designs is the original source for the Jacobsen 30-397. For more information or to view other designs, visit www.AssociatedDesigns.com or call 800-634-0123.

The Jacobsen's owners' suite boasts an exceptionally deep walk-in closet, plus a skylit bathroom