

Modern Rutherford has a vintage look

By Associated Designs

Victorian Stick homes were named for the stick-like decorative trusses highlighting the apexes of their gables. The Rutherford reflects this historically popular home style, with gently arched windows and gable end trusses, adding both grace and a contemporary touch.

Its multi-paned windows, generously sized porch with braced supports, and wide assortment of gables are also common features of this style. The stone veneer wainscoting and porch post supports show character, along with the eye-catching copper roof over the side window bay.

The nostalgia of times past transforms to present-day comfort once you step inside. The wide foyer and expansive, win-

dow-bright great room share a lofty two-story ceiling spanned by a second floor bridge. A wood-burning fireplace and wide home entertainment center are on the right, as is a passageway leading to the stairway, den, guest suite and bathroom.

Arched openings on the left of the great room feed into the dining room and kitchen. The dining room has six sides, two of them richly windowed. One side opens into a large walk-in wine cellar outfitted with a table at one end. Another

side features a passthrough counter linked to the kitchen.

Standing at the kitchen sink, you face into the great room through a second counter-level opening. A raised eating bar could be built here, but the dining room and nook already provide ample eating options. Counter and cupboard space in the large kitchen includes a work island and walk-in pantry. Laundry appliances are also close at hand, in a utility room connected to the garage.

The Rutherford's luxurious owners' suite is upstairs, along with two more bedrooms, a fourth bathroom, study loft, and skylit, unfinished bonus room.

Associated Designs is the original source for the Rutherford 30-411. For more information or to view other designs, visit www.AssociatedDesigns.com or call 800-634-0123.

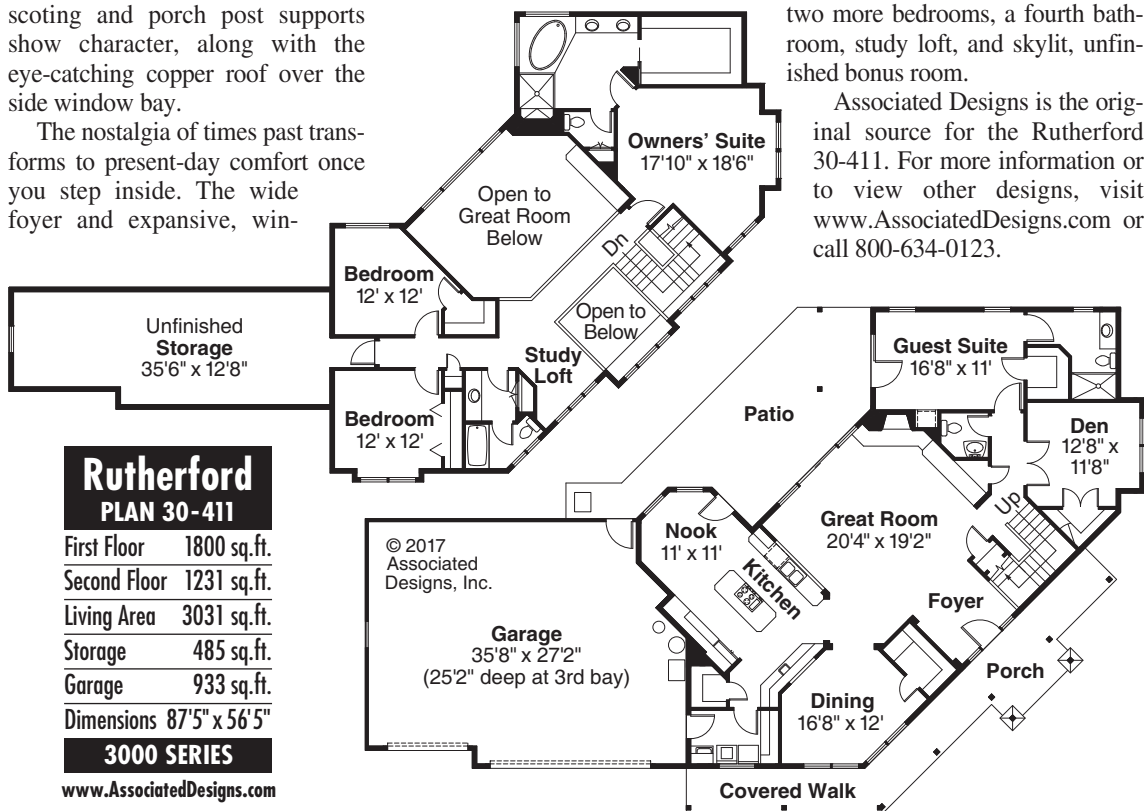

Rutherford PLAN 30-411

First Floor	1800 sq.ft.
Second Floor	1231 sq.ft.
Living Area	3031 sq.ft.
Storage	485 sq.ft.
Garage	933 sq.ft.
Dimensions	87'5" x 56'5"

3000 SERIES

www.AssociatedDesigns.com