

# Fetching Schuyler fits in town or country

By Associated Designs

If you're searching for a plan that takes full advantage of a rear view, check out the Schuyler. This contemporary shingle-style bungalow fits right in beside an ocean or lake, and is equally adaptable for year-round living in a suburban neighborhood.

Shake-textured siding covers most of the front, where Craftsman-style windows also invite admiring glances. A classic iron railing rims the front porch.

Plenty of natural light beams into the vaulted foyer through sidelights and a wide transom. Double doors on the left access a vaulted room that could be a den or home office. A narrower opening on the right links to secondary bedrooms and a bathroom.

At the far end of the foyer, a roomy coat closet is opposite the opening into the spacious

vaulted living room. With windows filling most of the rear wall, this area is as bright as it is large. A gas fireplace nestles into the far corner at the window's edge.

Two openings lead off the living room to the kitchen. The larger of the two opens into an area that could be furnished informally as an eating nook, or more formally as a dining room. Either way, people and potted plants will thrive in this window-bright environment.

The long, raised eating bar is great for snacking, chatting and homework supervision.

In the kitchen there's plenty of counter and cupboard space, built-in appliances, and a walk-in pantry. Laundry appliances are nearby, in a passthrough room that connects to the three-car garage.

Luxuries in the Schuyler's owners' suite include: a large walk-in closet, deep soaking tub, and dual vanity. Toilet and shower can be partitioned off for privacy and steam containment.

Associated Designs is the original source for the Schuyler 30-522. For more information or to view other designs, visit [www.AssociatedDesigns.com](http://www.AssociatedDesigns.com) or call 800-634-0123.

**Schuyler**  
**PLAN 30-522**

Living Area	2103 sq.ft.
Bonus Room	414 sq.ft.
Garage	840 sq.ft.
Dimensions	66' x 64'

**2000 SERIES**

[www.AssociatedDesigns.com](http://www.AssociatedDesigns.com)

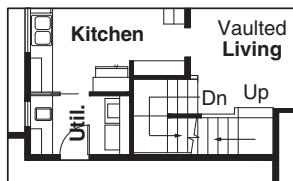
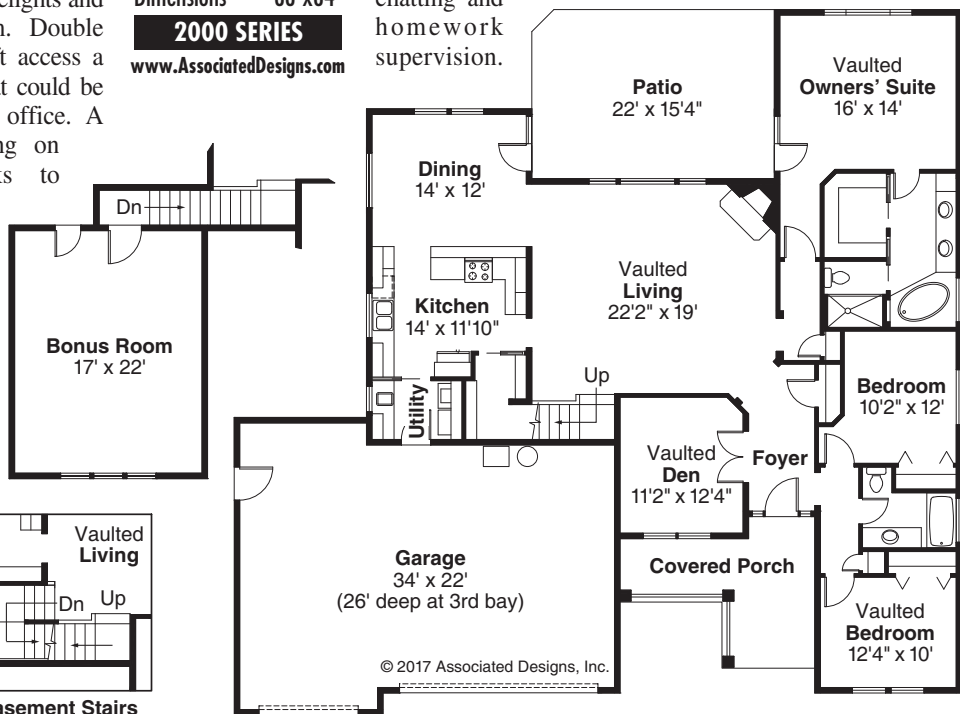

Alternate Basement Stairs