

# Attractive Ambrose is open and spacious

By Associated Designs

Looking at the Ambrose, there's plenty to enjoy. The bold brick veneer columns that accent the front facade of this traditional home are trimmed by soldier courses of raised brick. Gridded window uppers add visual interest to the expanses of glass, and a wavy ornamental railing highlights the front porch.

Inside, the mid-sized single-level floor plan provides an assortment of living spaces that enable contemporary family to both share time and find solitude. Double

doors on the right of the vaulted entry lead into a vaulted media room/study that could also be used as a home office. An arched opening on the left goes to the secondary bedrooms and main bathroom.

Continuing through the vaulted entry, you pass a coat closet on the left, and the kitchen's arched opening on the right. Then the space in front of you opens out into a bright and expansive great room. A mess-free gas fireplace nestles

into the left rear corner, and windows sparkle across most of the rear.

Standing in the kitchen, you can converse with people in the great room and dining room, while taking in outdoor scenes as well. The raised eating bar that divides the kitchen from these two linked rooms also serves to hide the inevitable clutter of a well-used kitchen. A roomy pantry fills one corner, and counters wrap around parts of all four sides. Just around the corner is a large pass-through utility room with a direct connection to the three-car garage.

Double doors open into the Ambrose's owners' suite, where a coffered ceiling adds to the modestly elegant ambiance. The suite has direct patio access, a deep walk-in closet, and a deluxe bathroom with a spa tub, oversized shower, dual vanity, and private toilet.

Associated Designs is the original source for the Ambrose 30-736. For more information or to view other designs, visit [www.AssociatedDesigns.com](http://www.AssociatedDesigns.com) or call 800-634-0123.

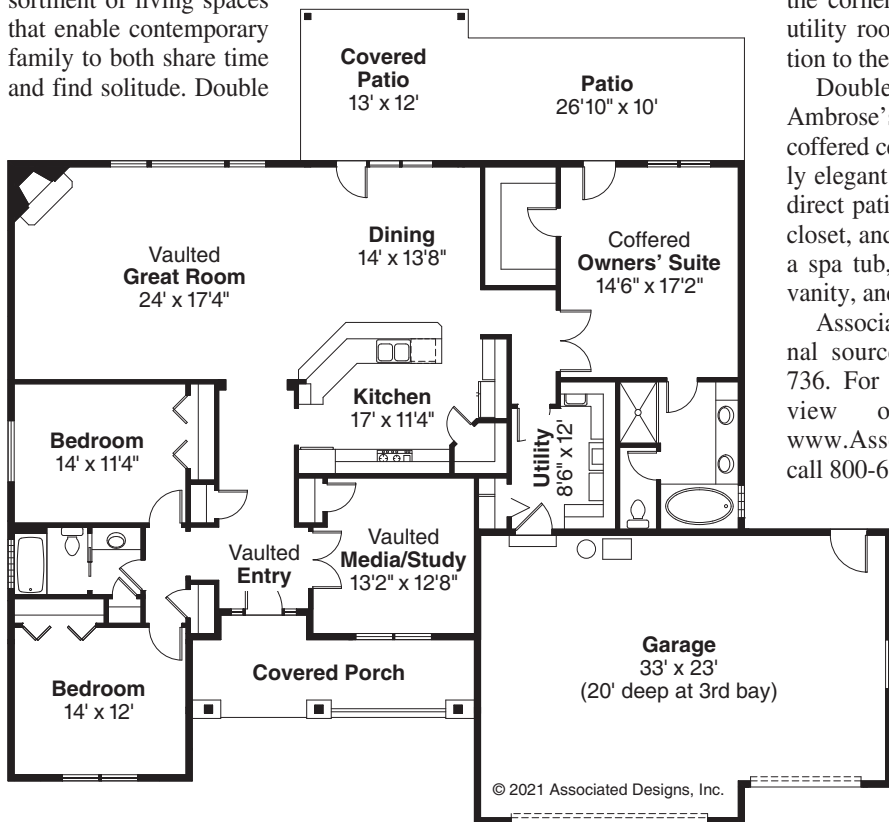

## Ambrose PLAN 30-736

Living Area 2316 sq.ft.

Garage 765 sq.ft.

Dimensions 72' x 66'

2000 SERIES

[www.AssociatedDesigns.com](http://www.AssociatedDesigns.com)