

Interesting angles and an abundance of family living spaces grace the interior of this Craftsman-style home. From the kitchen you can chat with people in the living room, serve quick meals on the raised eating bar, and keep tabs on activities in the patio and nook. An office and luxurious owners' suite fill the left wing. For more details, log onto [www.Home-Plan-Weekly.com](http://www.Home-Plan-Weekly.com), or call 1-800-634-0123.

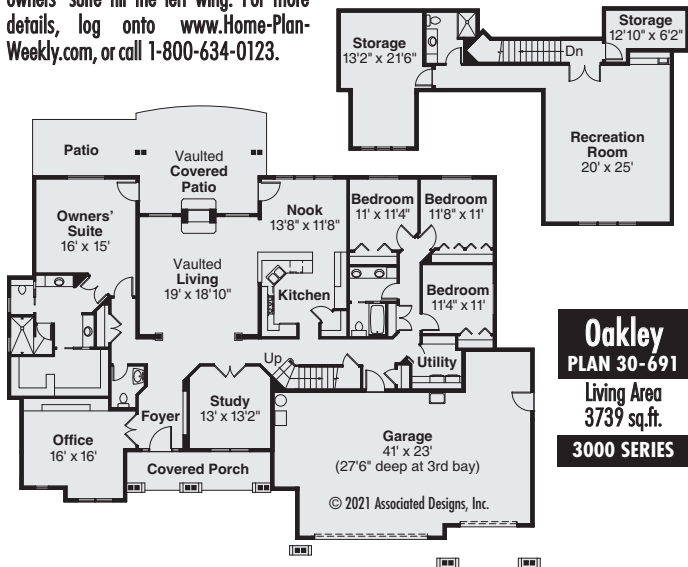

## Oakley PLAN 30-691

Living Area  
3739 sq.ft.

3000 SERIES